

# FLOOR PLANS

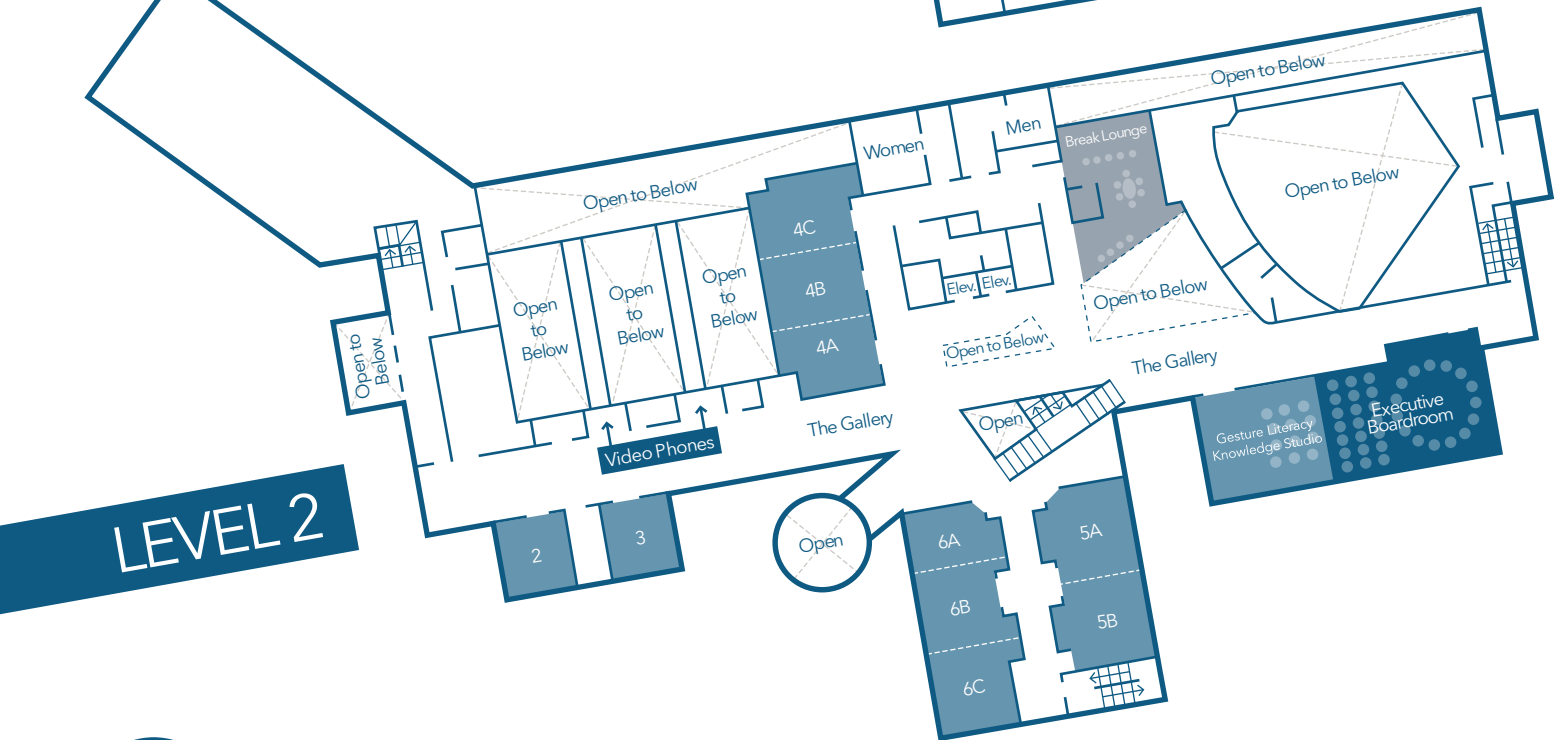
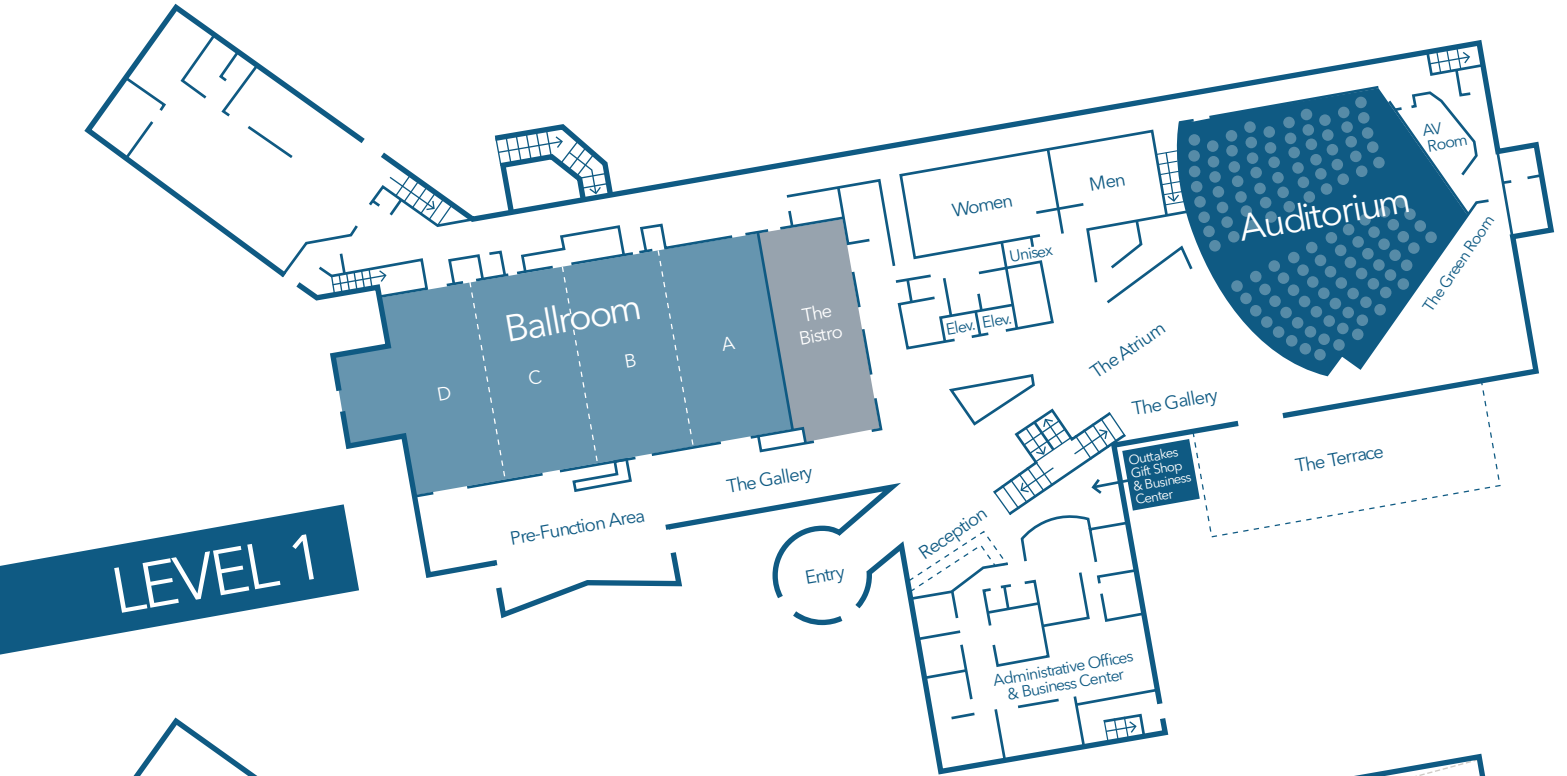

**Kellogg  
Conference  
Hotel**

At Gallaudet University

Teach | Inspire | Achieve

-  202.651.6100
-  [sales@gallaudet.edu](mailto:sales@gallaudet.edu)
-  [www.kelloggconferencehotel.com](http://www.kelloggconferencehotel.com)
-  800 Florida Ave N.E.  
Washington, D.C. 20002

# CAPACITY CHART

ROOM	DIMENSIONS	SQUARE FEET	CEILING	THEATRE	CLASSROOM	CONFERENCE	HOLLOW SQUARE	U-SHAPE	ROUNDS
Ballroom A	25' x 52' 2"	1,260	11' 3" - 13'	75	50	40	40	40	50
Ballroom B	25' x 52' 2"	1,275	11' 3" - 13'	75	50	40	40	40	50
Ballroom C	25' x 52' 2"	1,260	11' 3" - 13'	75	50	40	40	40	50
Ballroom D	25' x 52' 2"	927	11' 3" - 13'	50	35	20	20	20	60
A+B+C+D	98' x 52' 2"	4,722	11' 3" - 13'	275	185	140	140	140	210
Auditorium			11' 3" - 13'	275 Fixed seating					
2	25' 6" x 19' 6"	375	9' 2"	25	10	20	12	15	20
3	25' 6" x 19' 6"	375	9' 2"	25	10	20	12	15	20
4A	24' 4" x 19' 9"	475	9'	25	20	20	20	20	20
4B	24' 4" x 18'	438	9'	25	20	20	20	20	20
4C	24' 4" x 20' 6"	499	9'	25	20	20	20	20	20
4A+4B+4C	24' 4" x 58'	1,412	9'	75	60	60	60	60	60
5A	22' x 16' 9"	369	9' 2"	20	20	15	15	15	20
5B	22' x 16' 9"	655	9' 2"	30	20	15	15	15	30
5A+5B	22' x 46' 6"	1,024	9' 2"	50	50	30	30	30	50
6A	22' x 16' 9"	369	9' 2"	25	20	20	20	20	20
6B	22' x 18'	396	9' 2"	25	20	20	20	20	20
6C	22' x 21' 3"	468	9' 2"	25	20	20	20	20	20
6A+6B+6C	22' x 56'	1,233	9' 2"	75	60	60	60	60	60
Executive Boardroom	26' 6" x 44' 5"	1,184	10'	30				22	
Break Lounge	26' 6" x 30'	780	8' 6"						



**Kellogg  
Conference  
Hotel**

At Gallaudet University

Teach | Inspire | Achieve

-  202.651.6100
-  [sales@gallaudet.edu](mailto:sales@gallaudet.edu)
-  [www.kelloggconferencehotel.com](http://www.kelloggconferencehotel.com)
-  800 Florida Ave N.E.  
Washington, D.C. 20002